



Table Clamp

- 12.1735 TC-OH Light
- 12.1730 TC-OH
- 12.1740 TC-OH HD

Sicherheitshinweise
Safety Instructions



Montage
Assembly Instructions



Handhabung
Handling



2021-07-15

00.5163~A

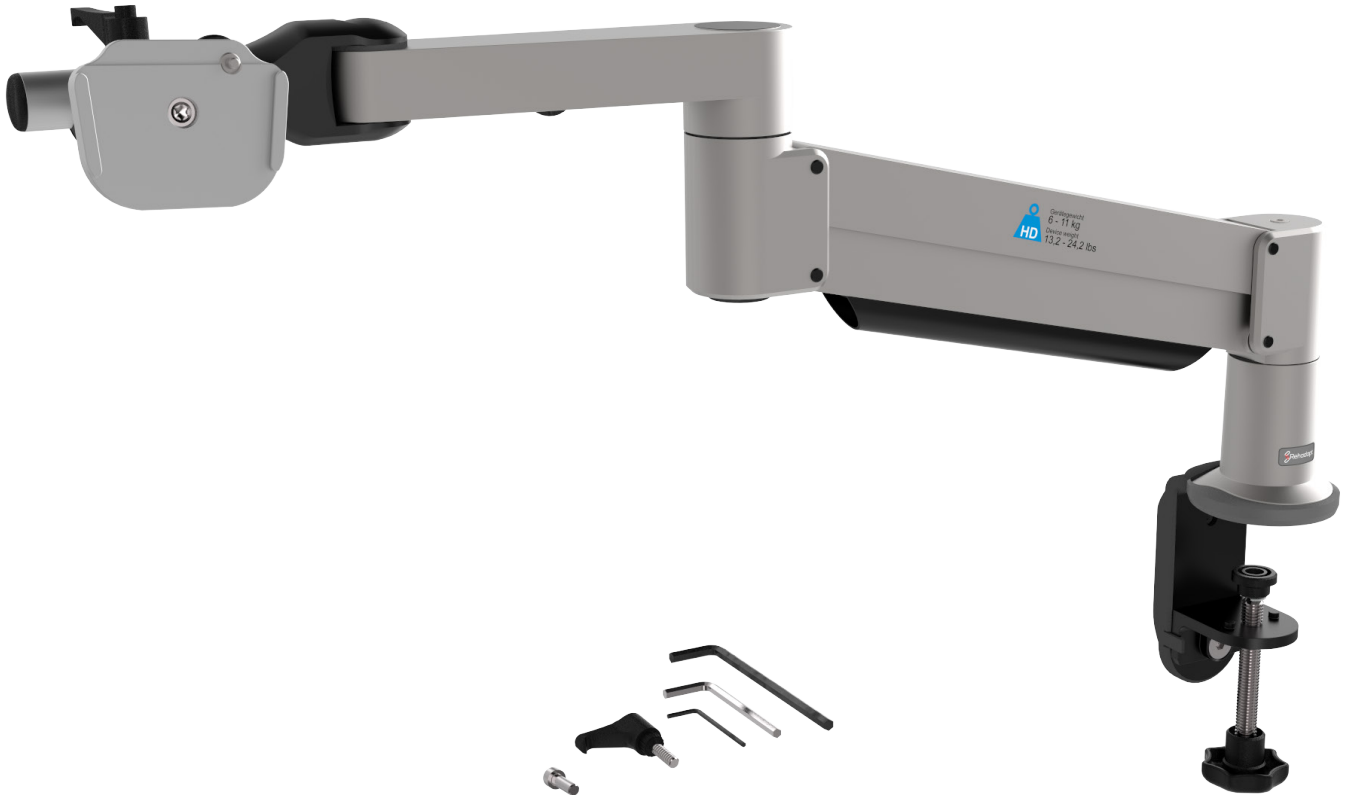

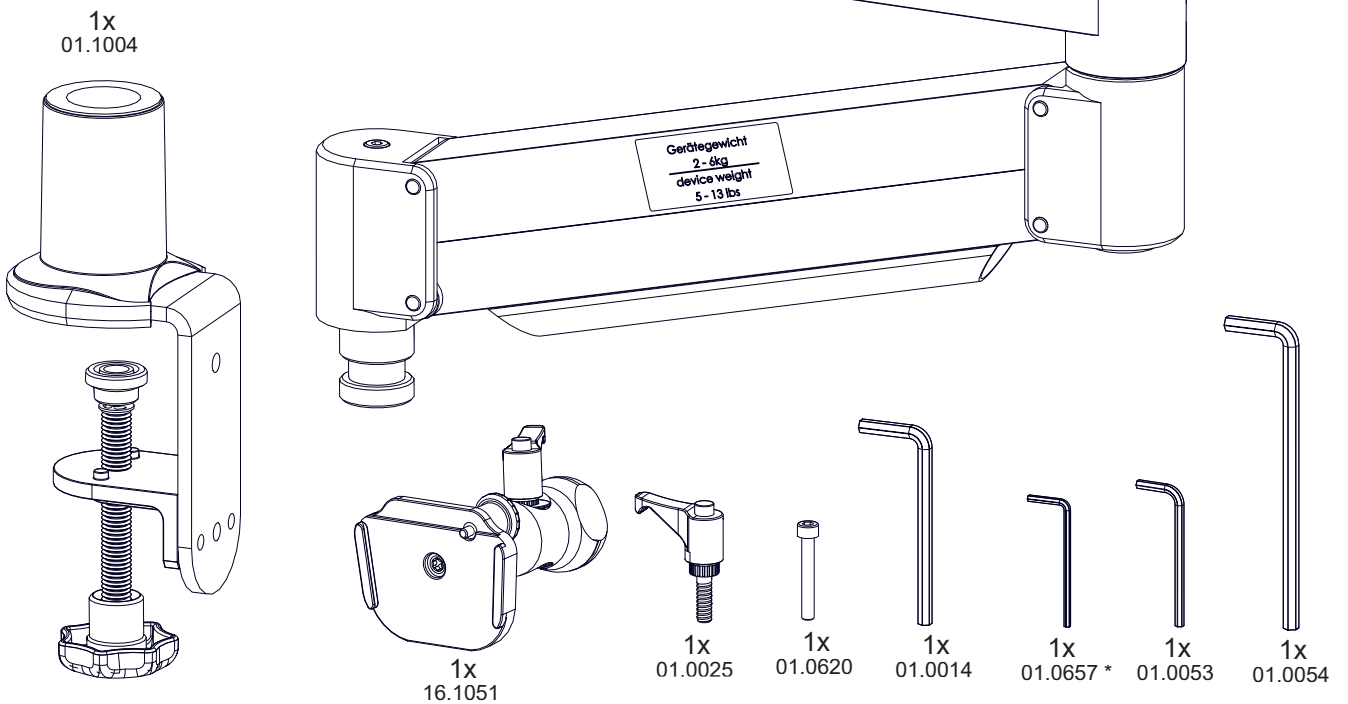
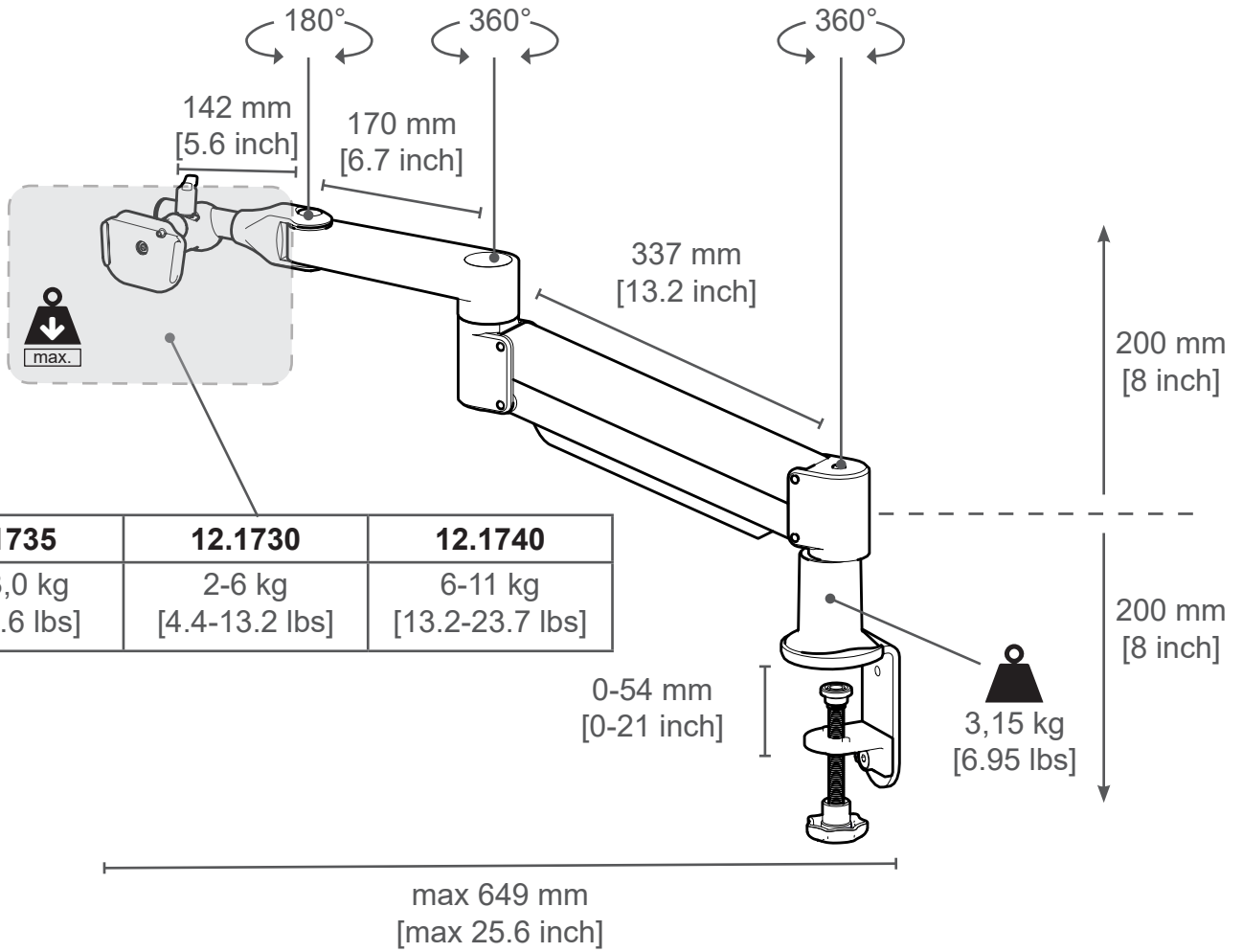

* 12.1735

1

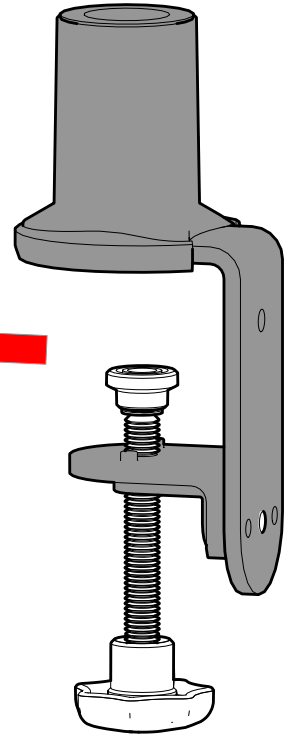
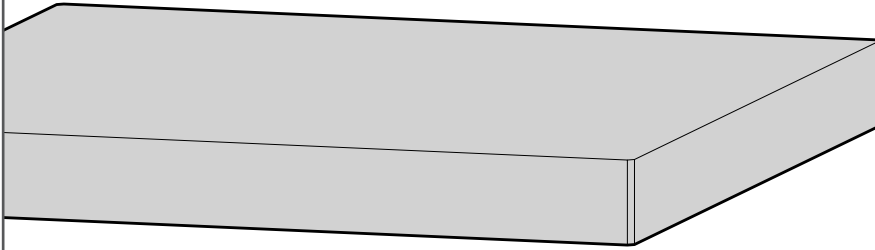
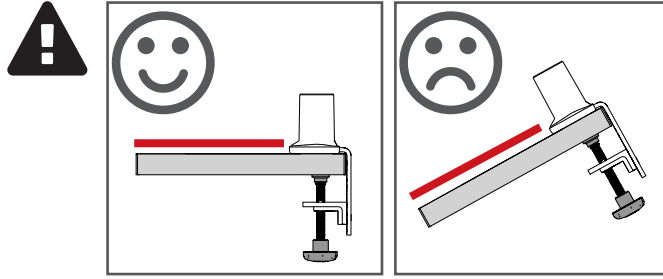

2

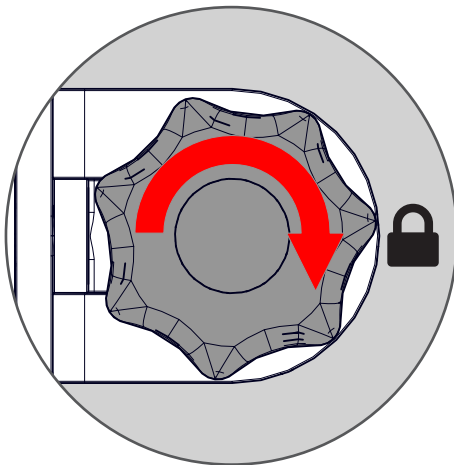
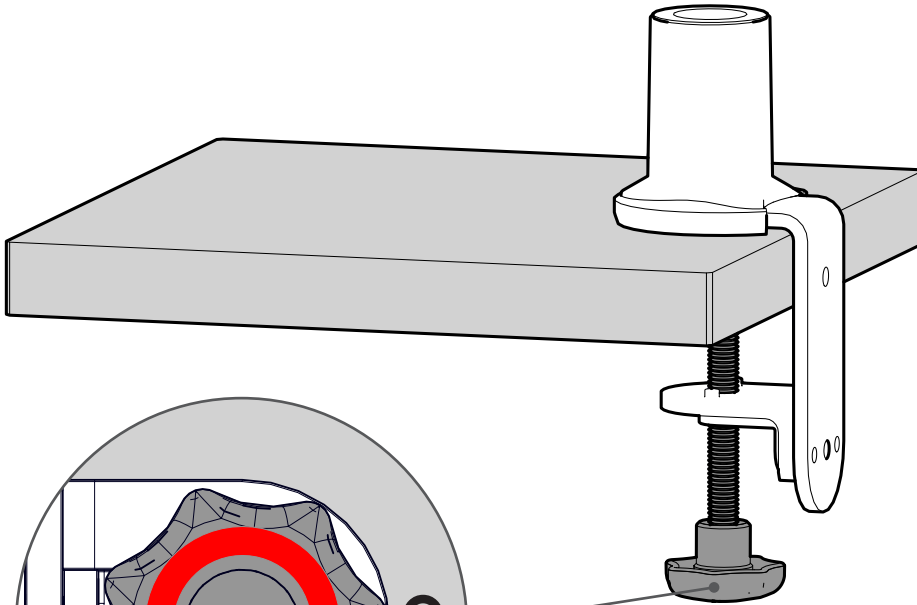

3

3

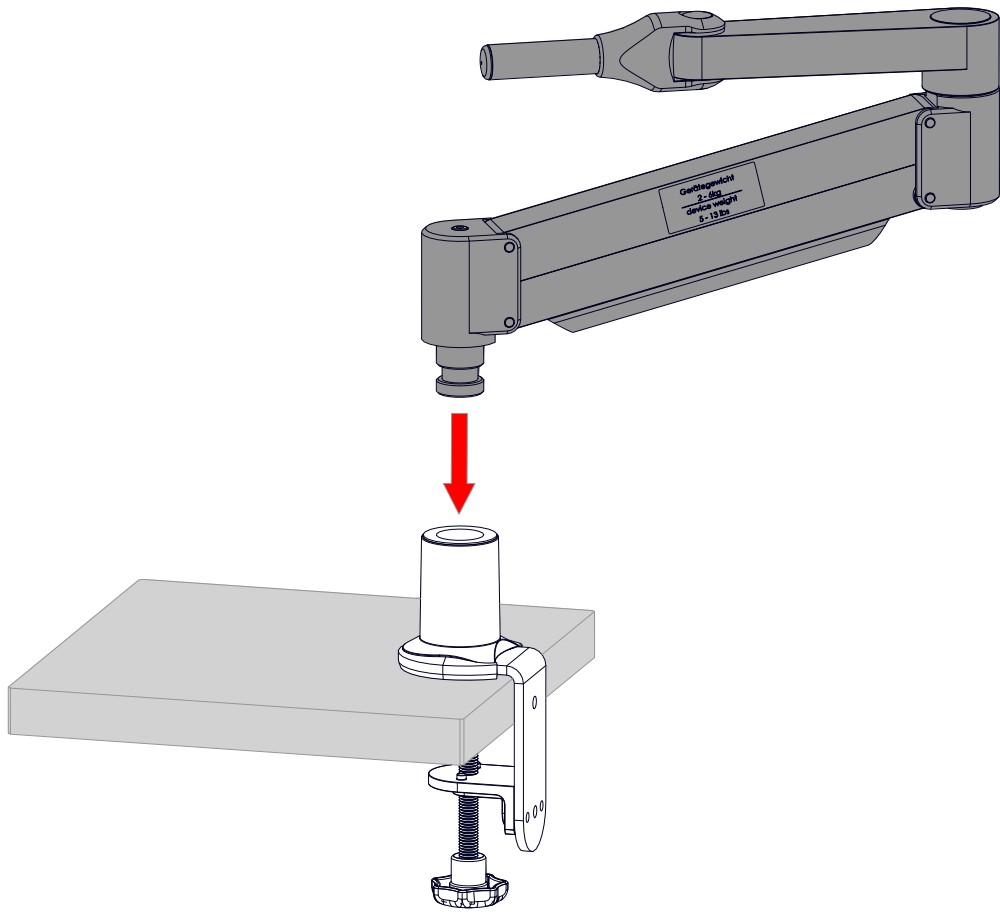

4

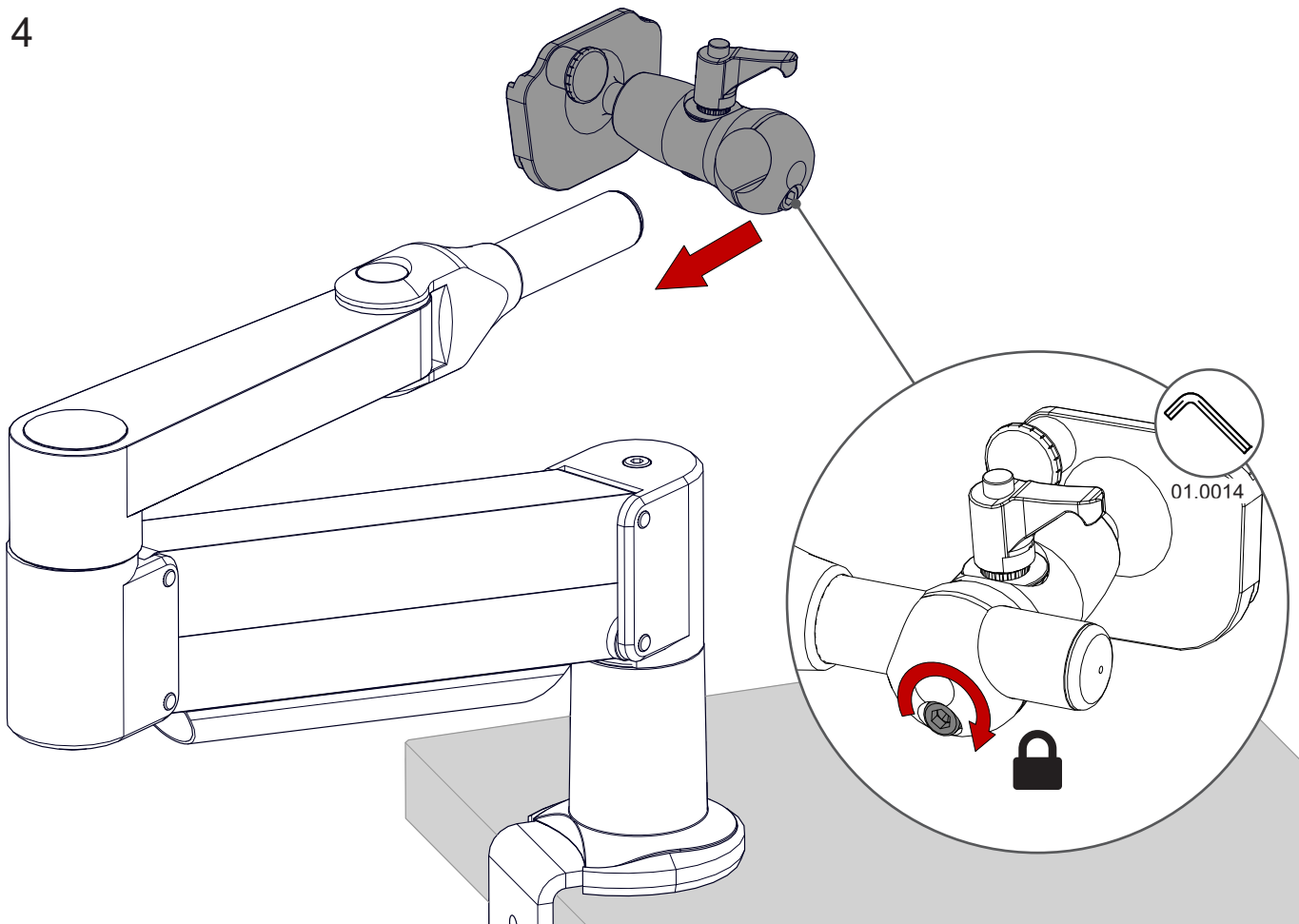

5

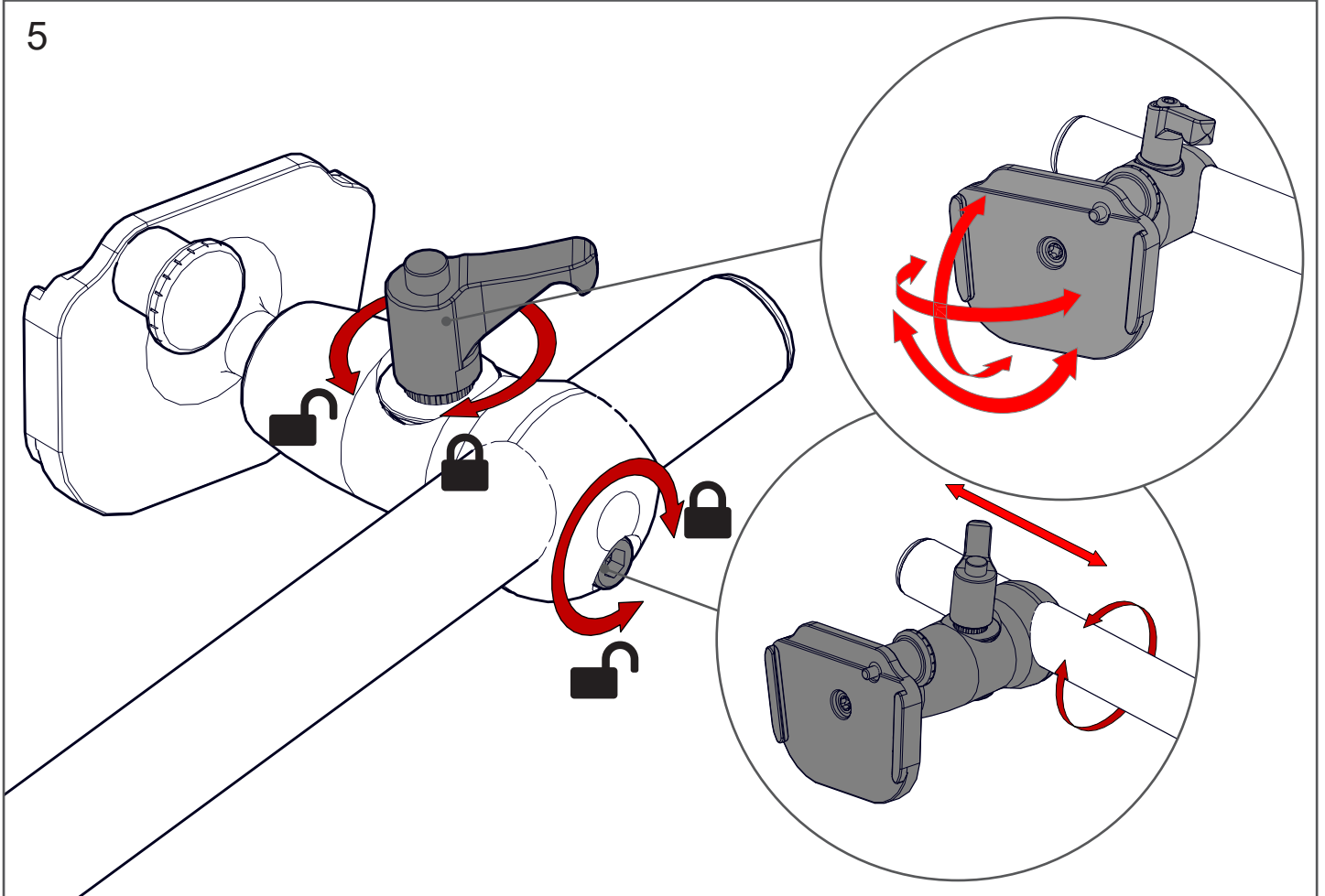

6

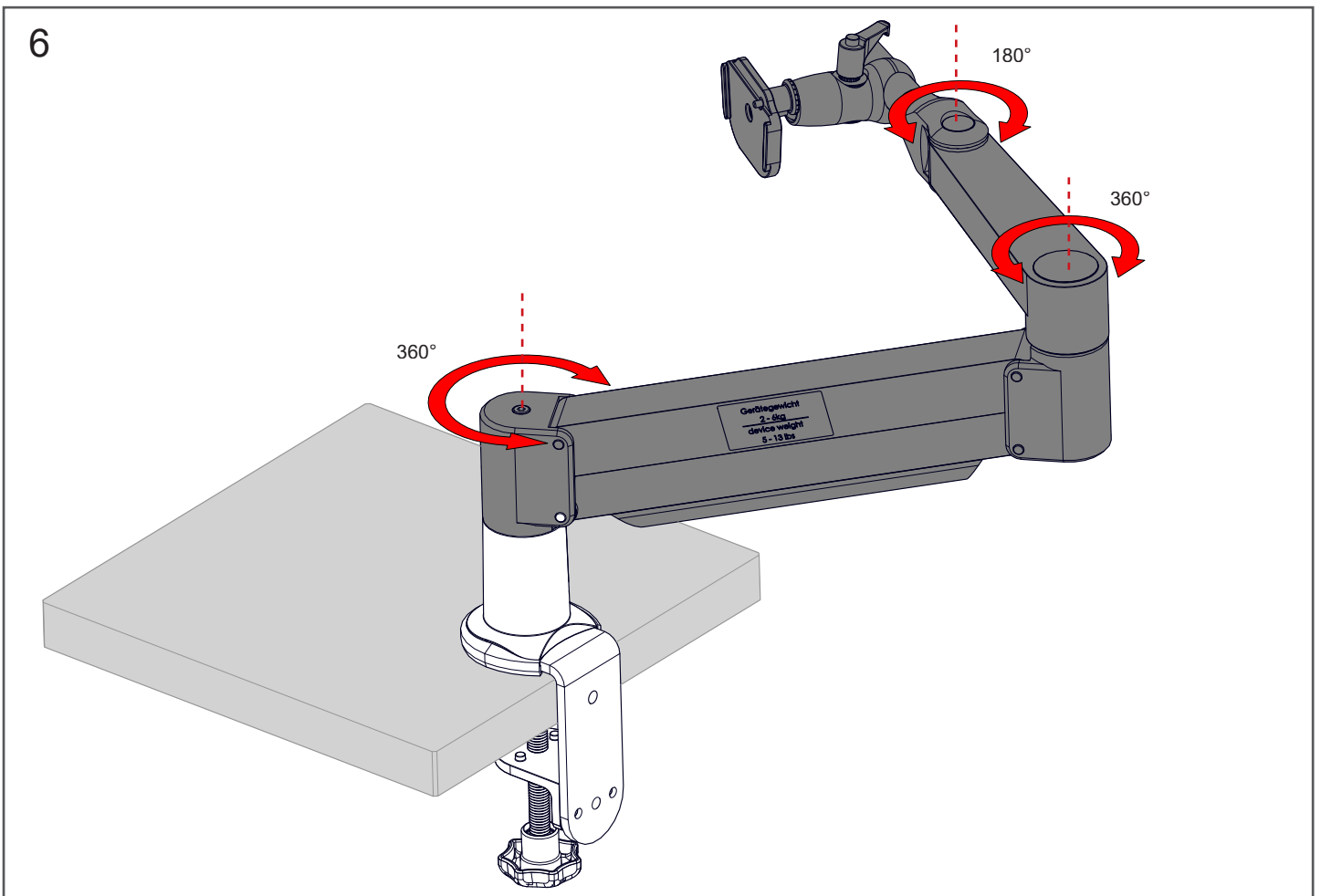



IMPORTANT!

- Device must be on arm
- Arm must be in mount



WICHTIG!

- Gerät muss montiert sein
- Arm muss in Halterung sein

Bring the arm to a position approximately horizontal prior to turning the strength adjustment screw.

Vor dem justieren der Einstellschraube drücken Sie den **Arm nach unten bis er ungefähr parallel zur Grundfläche ist.**

If the arm **drifts upward**, turn the adjustment screw clockwise.

Wenn der Arm **nach oben driftet**, drehen Sie die Einstellschraube im Uhrzeigersinn.

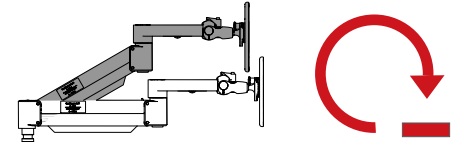
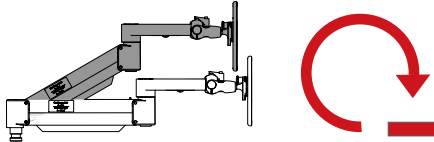

If the arm **drifts downward**, turn the adjustment screw counter-clockwise.

Wenn der Arm **nach unten driftet**, drehen Sie die Einstellschraube gegen den Uhrzeigersinn.

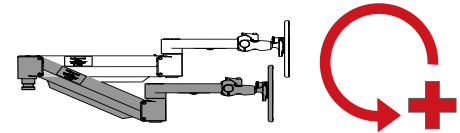
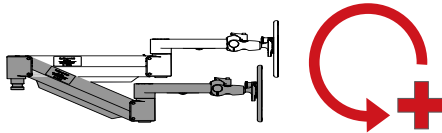

Depending on the weight of your device, **you may have to make 15-20 turns.**

Abhängig vom Gewicht Ihres Gerätes, müssen Sie möglicherweise **15-20 Umdrehungen durchführen.**

1

01.0054

Gerätgewicht
3-8kg
maximales
8-10kg

EN

In some instances, further counterbalance adjustments are needed to allow the arm's instant height adjustment function to work properly.

If your arm is not staying in position after performing step 1, follow these steps:

With arm in raised position, tighten set screw (A)

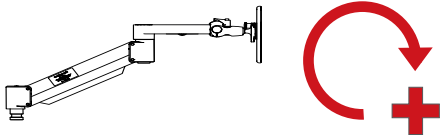

With arm in horizontal position, tighten set screw (B)

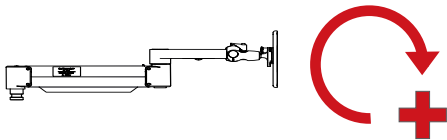

Do not overtighten the screws.

DE

In einigen Fällen sind weitere Gegengewichtseinstellungen notwendig, damit die korrekte Höheneinstellung des Arms möglich ist.

Wenn dein Arm nach der ersten Variante nicht in der gewünschten Position bleibt, folge diesen Schritten:

Mit erhobenem Arm, Linsenkopfschraube anziehen (A)

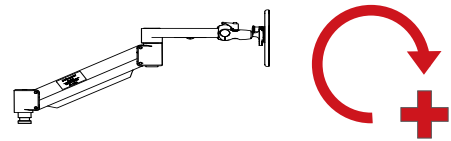

Mit Arm in horizontaler Position, Gewindestift anziehen (B)

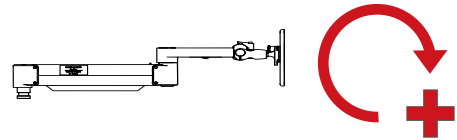

Schrauben nicht zu fest anziehen.

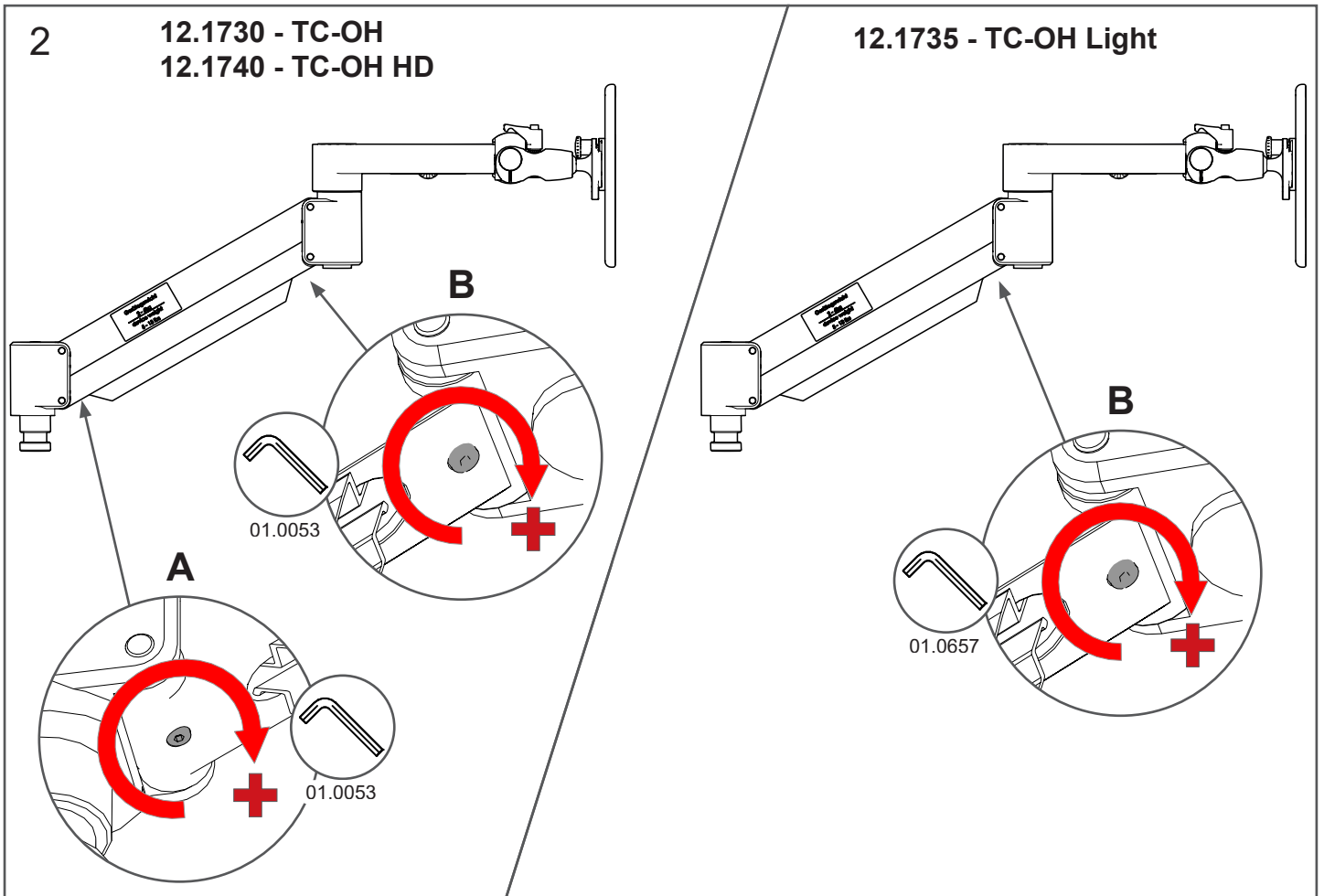

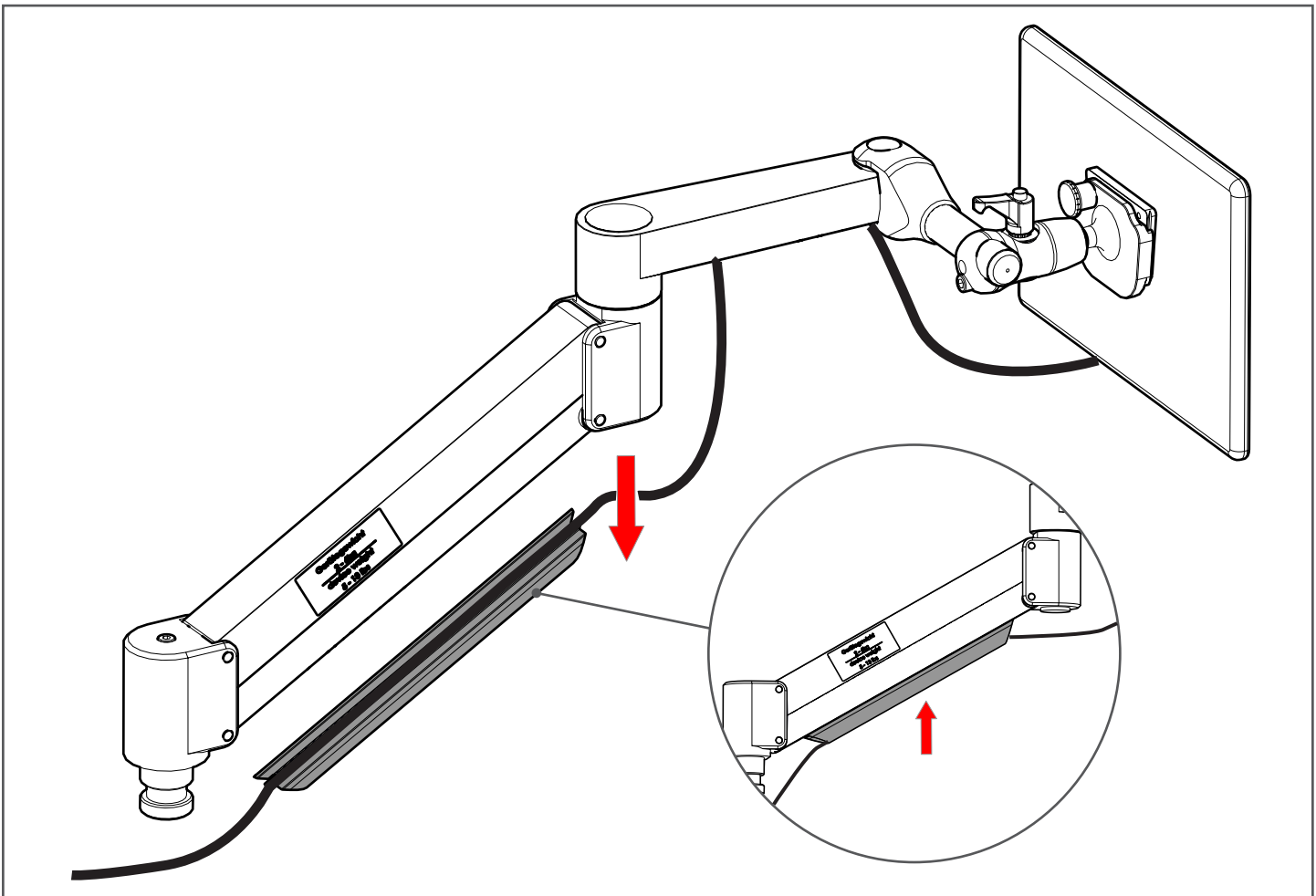
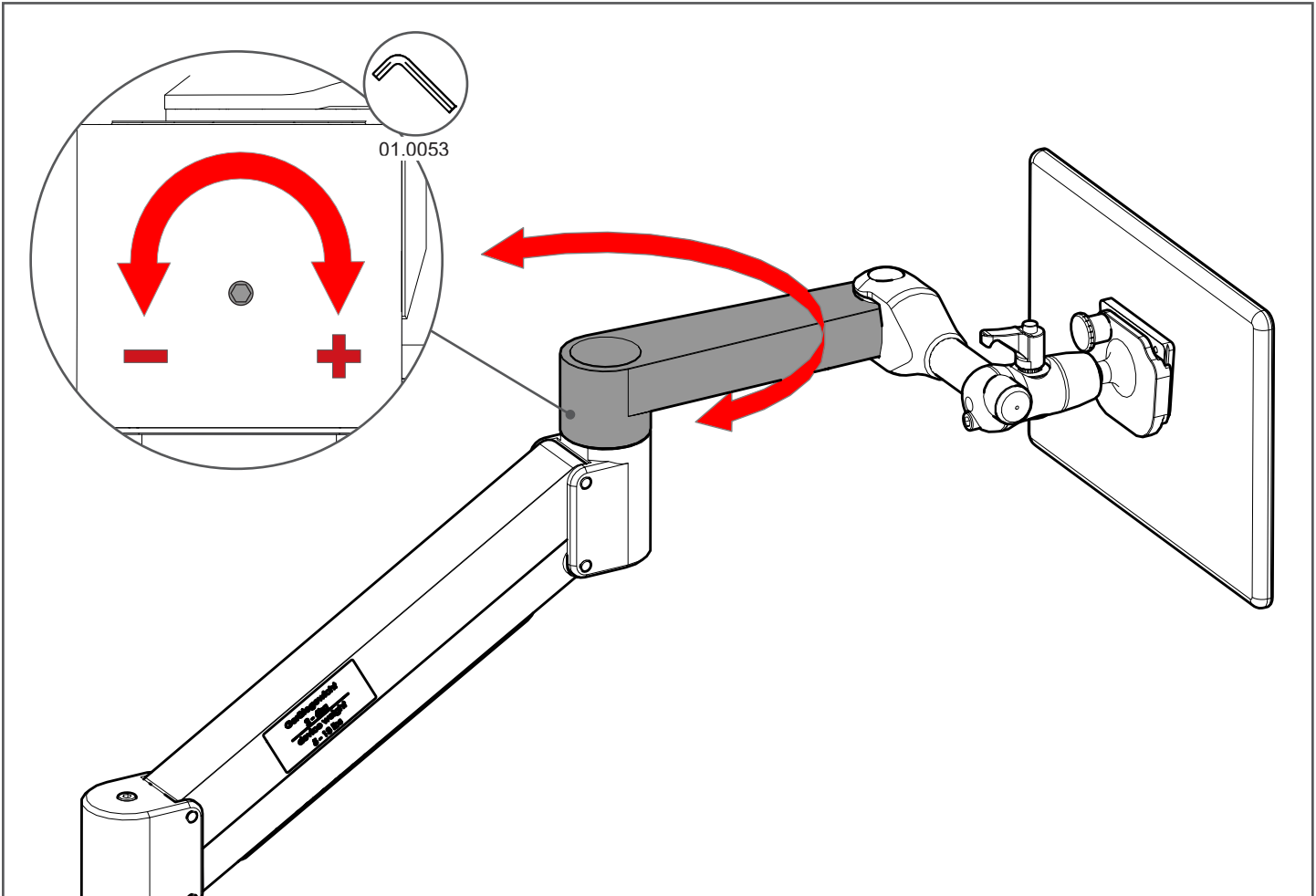

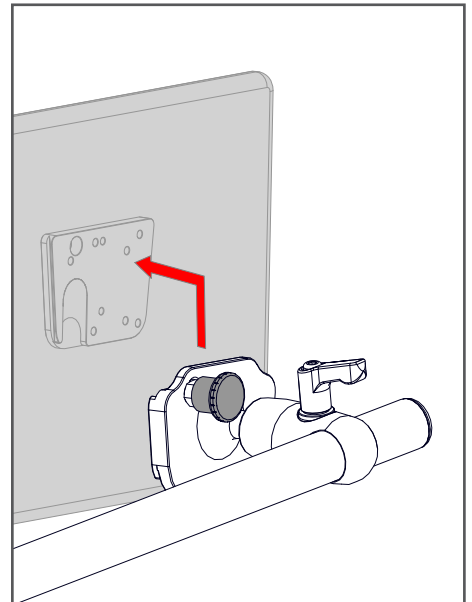
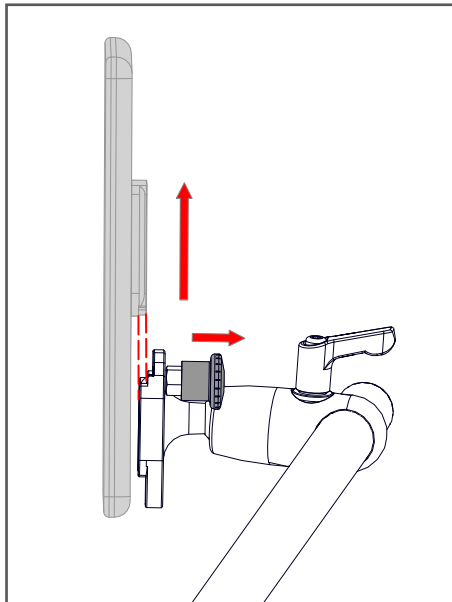
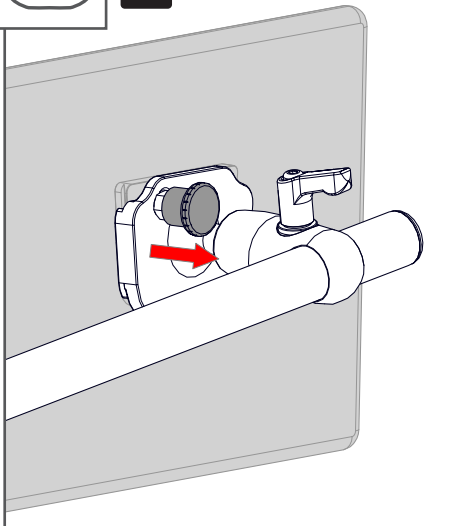
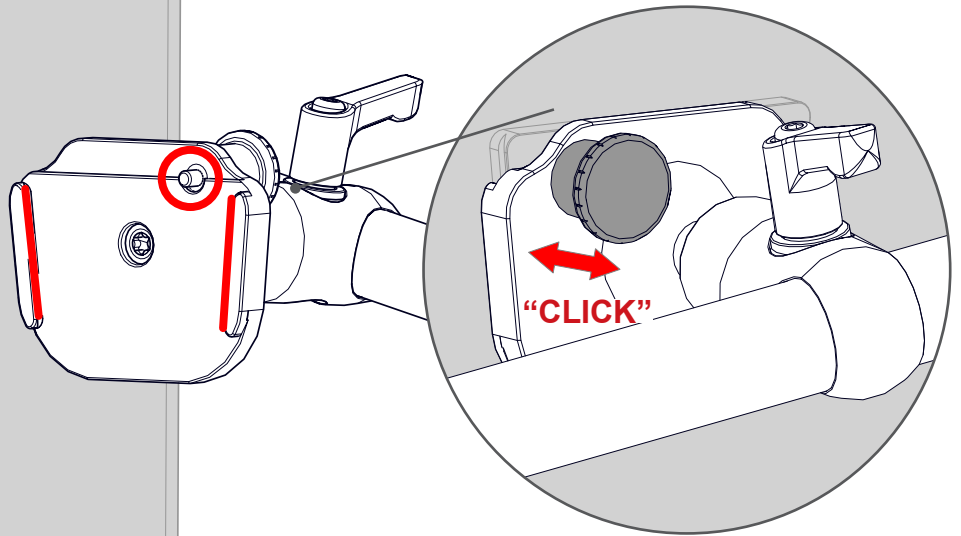
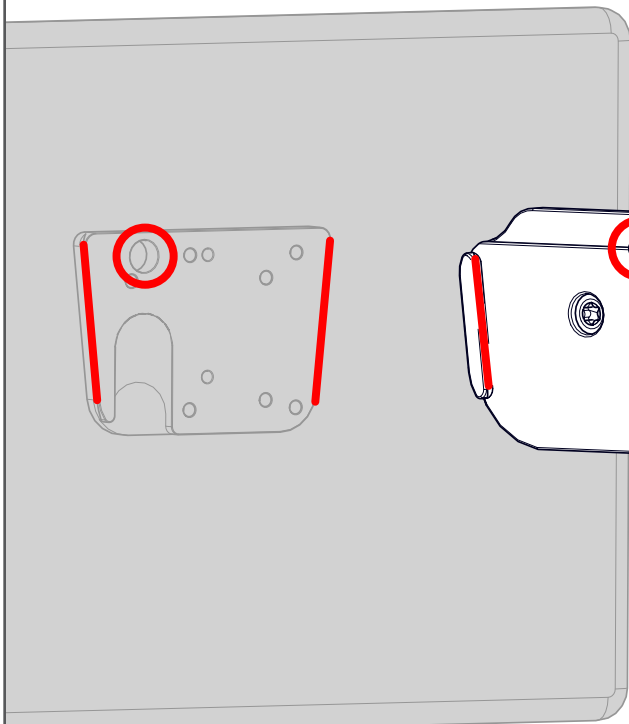
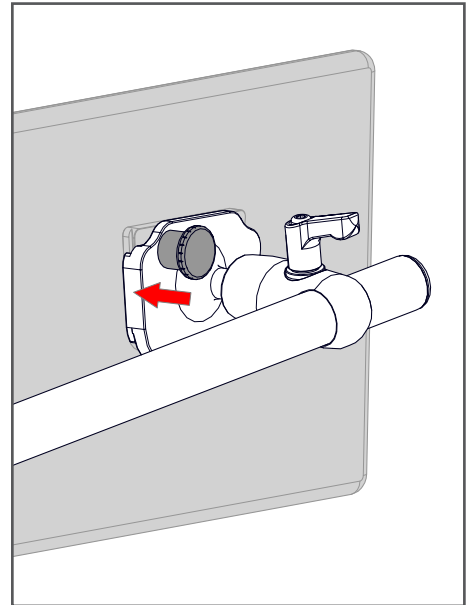
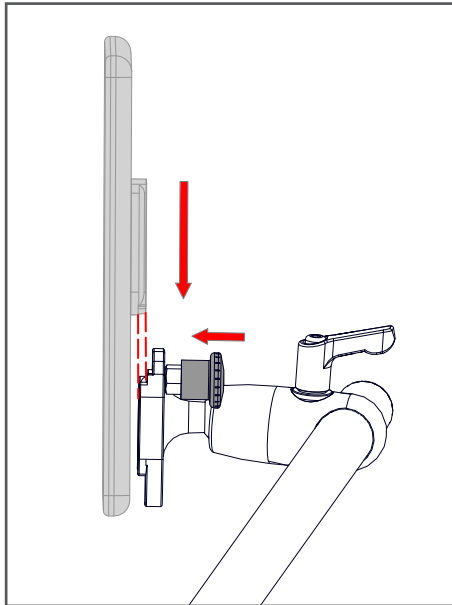
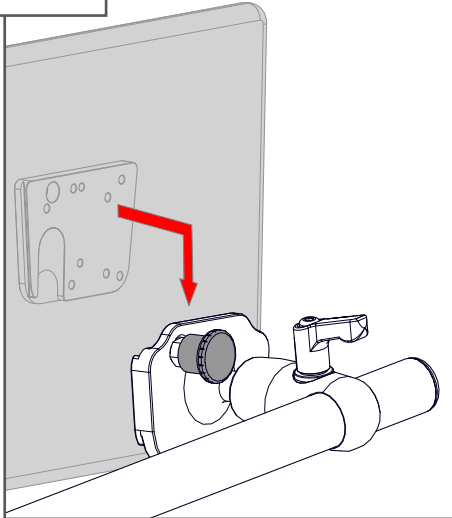

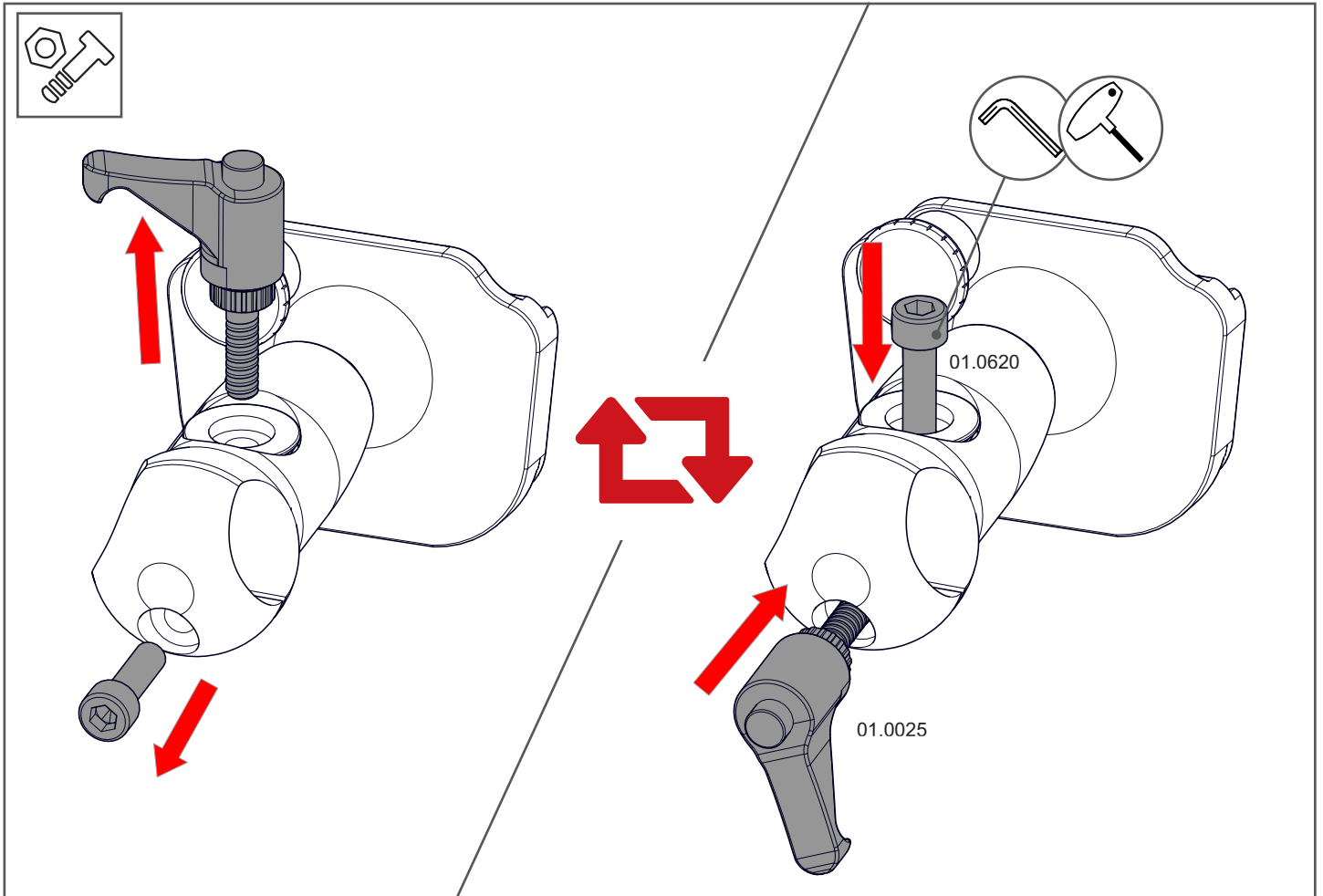

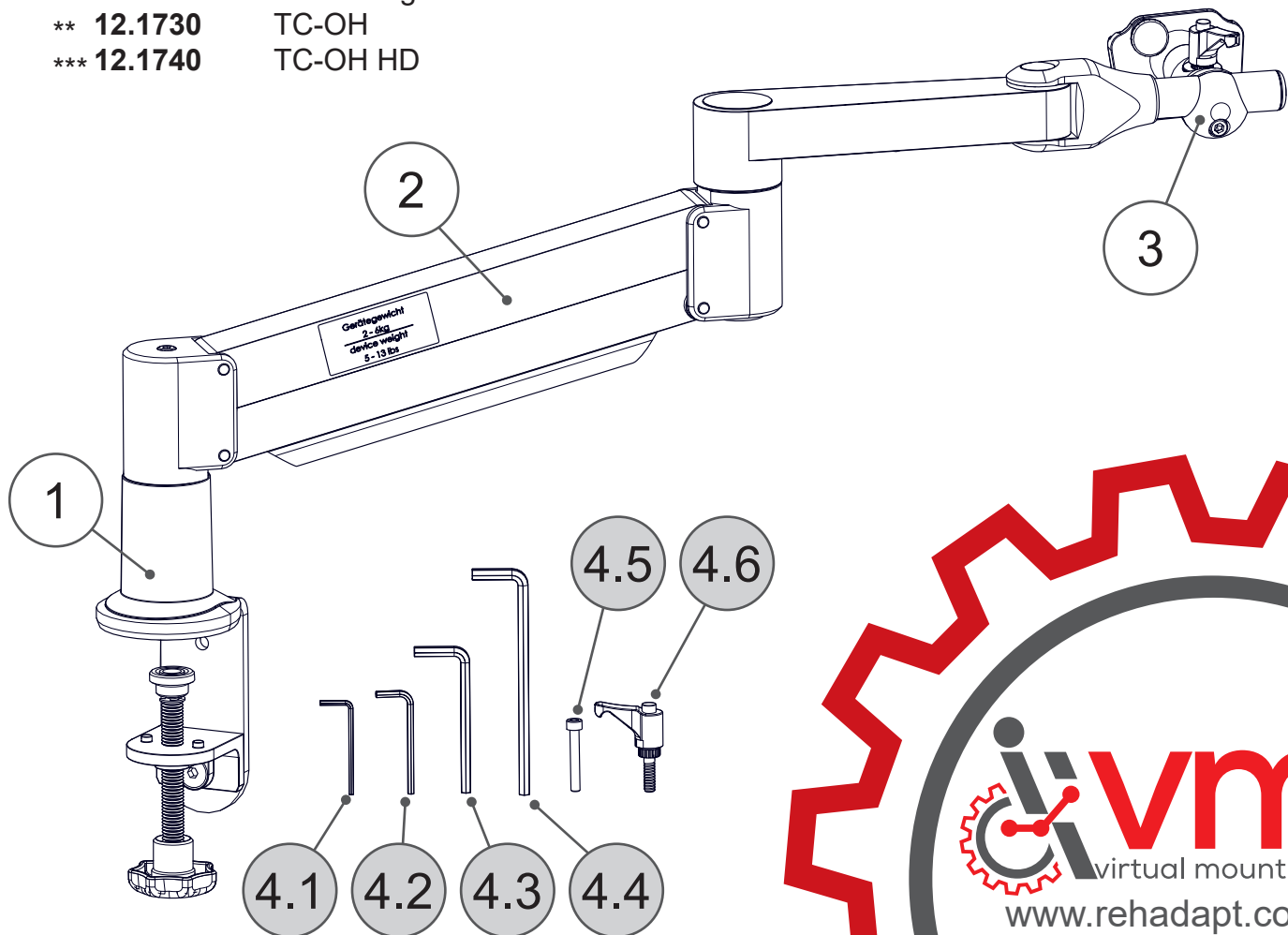

Pos.	No.	Bezeichnung	Description
1	01.1004	Klemme FloatArm	Clamp FloatArm
2*	17.9614	FS Arm Float Light	FS Arm Float Light
2**	17.9610	FS Arm Float	FS Arm Float
2***	17.9611	FS Arm Float HD	FS Arm Float HD
3	16.1051	UGA-22-DC	UDS-22-DC
4.1	01.0053	Innensechskantschlüssel 3/32"	Allen wrench 3/32"
4.2*	01.0657	Innensechskantschlüssel 1/8"	Allen wrench 1/8"
4.3	01.0014	Innensechskantschlüssel 5mm	Allen wrench 5mm
4.4	01.0054	Innensechskantschlüssel 7/32"	Allen wrench 7/32"
4.5	01.0620	Zylinderschraube M6x20	Cylinder Head Bolt M6x20
4.6	01.0025	Klemmhebel M6x20	Clamping Lever M6x20

- * **12.1735** TC-OH Light
- ** **12.1730** TC-OH
- *** **12.1740** TC-OH HD

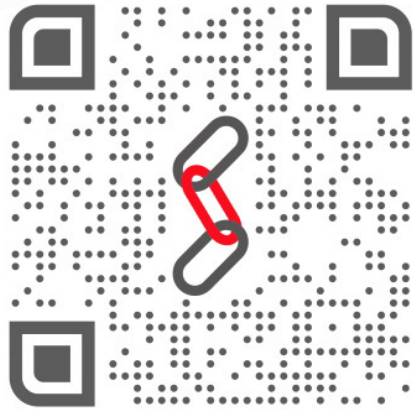



 Rehadapt Engineering
GmbH & Co. KG

📄 Heinrich-Hertz-Str. 104
34123 Kassel, Germany

☎ Tel.: +49 561 220 717 0
📠 Fax: +49 561 220 717 99

✉ officeteam@rehadapt.com
🌐 <https://rehadapt.com>

 Rehadapt
North America

📄 40-01 Oser Ave
Hauppauge, NY 11788, USA

☎ Tel.: 1 (888) 635-6962
📠 Fax: 1 (888) 635-6962

✉ officeteam.na@rehadapt.com
🌐 <https://rehadapt.com>